

# Aluseal AC100

Aluminium covers [Formerly known as Alu-Cover]

## DESCRIPTION

Extruded Aluminium Cover designed to protect and conceal expansion joints in civil engineering structures.

## APPLICATIONS

Aluseal AC100 is used as a decorative cover to protect expansion joints, concealing any irregularities in these joints.

## ADVANTAGES

- » Protect sealants from physical damages.
- » Able to withstand joint movement.
- » Easy to apply.
- » Suitable for internal and external application.

## DESIGN CRITERIA

Aluseal AC100 is designed for use with or without clips for joints width between 10 – 70 mm.

Aluseal AC100 is available in five different profiles for use in floors, walls and corners.

| Profile     | Weight     | Width   | Joint size | Uses           |
|-------------|------------|---------|------------|----------------|
| AC100-90    | 0.50 kg/LM | 91.0 mm | 10 - 70    | Floors & Walls |
| AC100-70    | 1.08 kg/LM | 69.2 mm | 10 - 50    | Floors & Walls |
| AC100-60    | 0.88 kg/LM | 60.0 mm | 10 - 40    | Floors & Walls |
| AC100-59x59 | 0.49 kg/LM | 56.0 mm | 10 - 40    | Corners        |
| AC100 Angle | 0.66 kg/LM | 52.0 mm | 10 - 40    | Corners        |

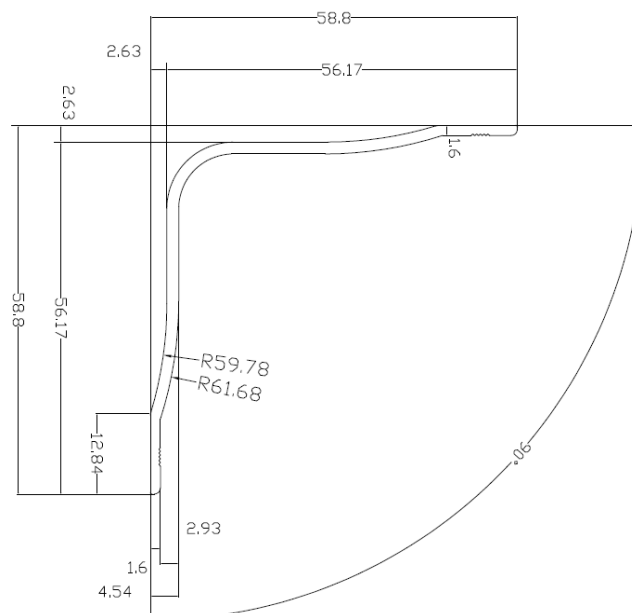

## PACKAGING

Available in 3 meter long strips.

## STORAGE

Store in good condition to eliminate damages.

## CAUTIONS

## HEALTH AND SAFETY

There are no health hazards associated with Aluseal AC100 in normal use.



# Aluseal AC100

## Wall- Corner Joint Detail

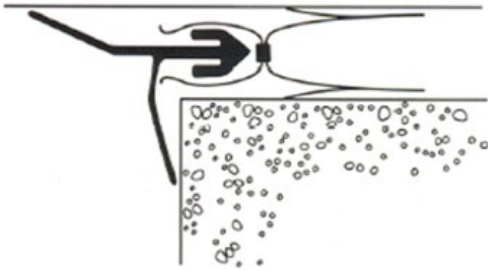

## MORE FROM DON CONSTRUCTION PRODUCTS

A wide range of construction chemical products are manufactured by DCP which include:

- » Concrete admixtures.
- » Surface treatments
- » Grouts and anchors.
- » Concrete repair.
- » Flooring systems.
- » Protective coatings.
- » Sealants.
- » Waterproofing.
- » Adhesives.
- » Tile adhesives and grouts.
- » Building products.
- » Structural strengthening.

## Floor Joint

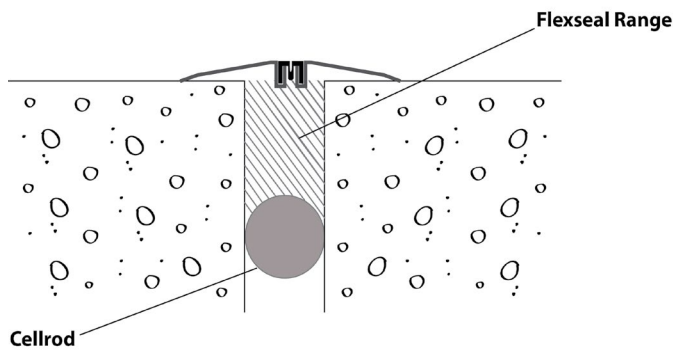

## Floor Joint

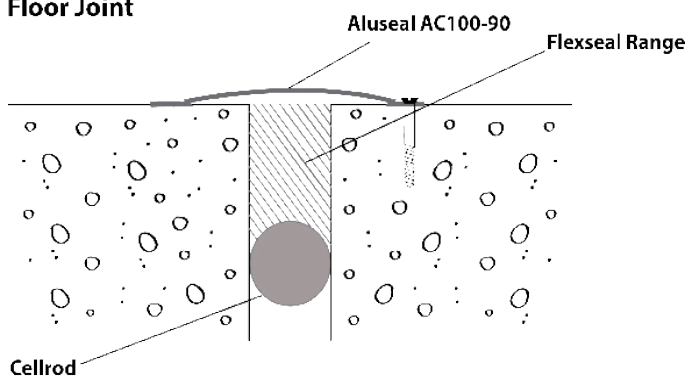

## Don Construction Products / Jordan

Ma'adaba, Jordan

[info.jordan@dcp-int.com](mailto:info.jordan@dcp-int.com)

[www.dcp-int.com](http://www.dcp-int.com)

### Note:

We endeavour to ensure that any information, advice or recommendation we may give in product literature is accurate and correct. However, because we have no control over where and how products are applied, we cannot accept any liability arising from the use of the products.

[www.dcp-int.com](http://www.dcp-int.com)

DCP Building Excellence